

2408

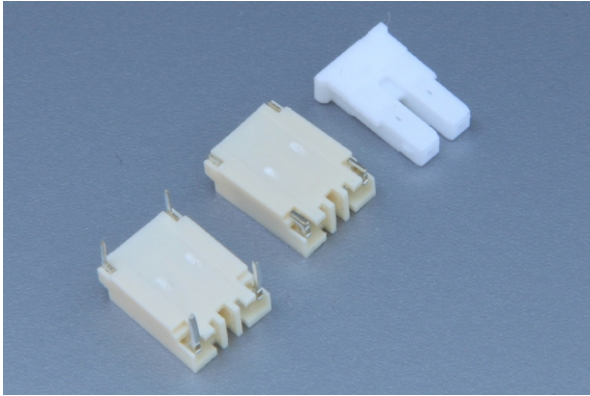

Pitch 3.5mm Wire to Board Connectors - SMT Type



PERFORMANCE

Electrical Rating: AC/DC 1400V 1A
 額定電壓電流
 Insulation Resistance: 1000MΩ min.
 絕緣阻抗
 Withstanding Voltage: 3800V AC/minute
 耐電壓
 Temperature Range: -25°C~+85°C
 適用溫度



CONNECTOR

Part No.: MS2408P2

產品編號

MS2408P2 RF:D (Lock Type)

Material: Housing: Nylon 94V-0

材質 塑膠座

Contact Pin: Brass, Tin-plated

接觸針 黃銅, 鍍錫

Suitable Contact: 2408PS-2

配合端子

Suitable Housing: P2408P2

配合塑膠

Applicable Wire: AWG# 24~28

適用電線

Packing: 1,000PCS (Reel)

包裝數量

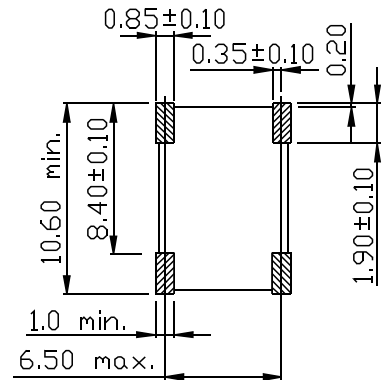
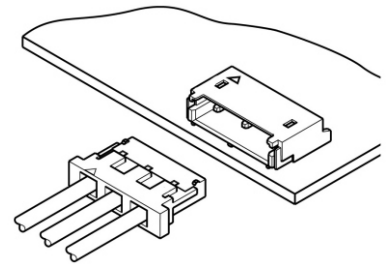

P.C.B LAYOUT

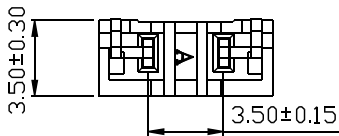

P/No. MS2408P2 RF:D
 LOCK Type

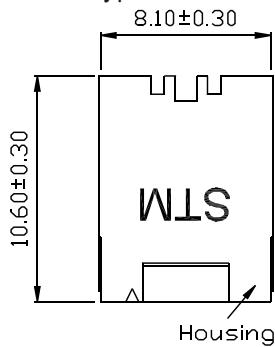

P/No. MS2408P2

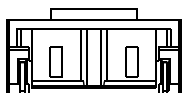
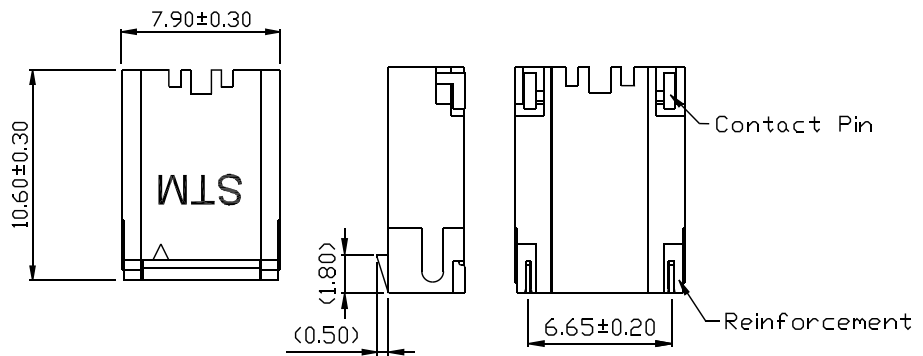

3.50mm

2408 Wire to Board Connectors

CONNECTOR - Side Entry Type

Part No.: **M2408P2R**

產品編號

Material: Housing: Nylon 94V-0

材質

塑膠座

Contact Pin: Brass, Tin-plated

接觸針

黃銅

鍍錫

Suitable Contact: 2408PS-2

配合端子

Suitable Housing: P2408P2

配合塑膠

Applicable Wire: AWG# 24~28

適用電線

Packing: 600PCS (Reel)

包裝數量

PERFORMANCE

Electrical Rating: AC/DC 1400V 1A

額定電壓電流

Insulation Resistance: 1000MΩ min.

絕緣阻抗

Withstanding Voltage: 3800V AC/minute

耐電壓

Temperature Range: -25°C~+85°C

適用溫度

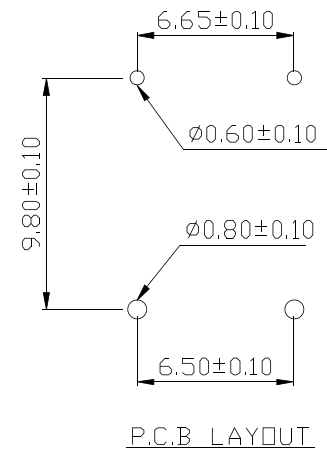
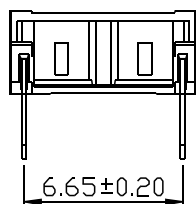
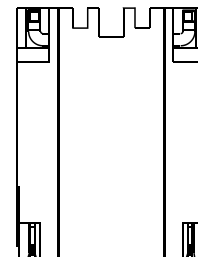
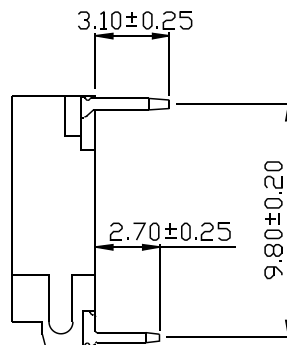
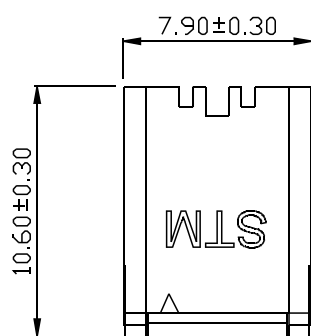
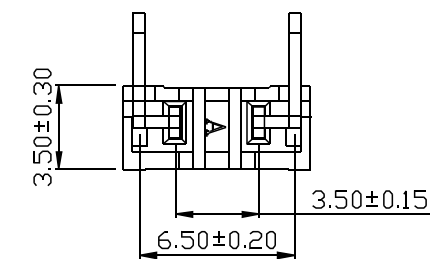

3.50mm

HOUSING

Part No.: **P2408P2**

產品編號

Material: Nylon 94V-0

材質

Suitable Contact: 2408PS-2

配合端子

Suitable Connector: M2408P2R MS2408P2

配合公座

Applicable Wire: AWG# 24~28

適用電線

Packing: 1,000PCS (Bag)

包裝數量

PERFORMANCE

Electrical Rating: AC/DC 1400V 1A

額定電壓電流

Insulation Resistance: 1000MΩ min.

絕緣阻抗

Withstanding Voltage: 3800V AC/minute

耐電壓

Temperature Range: -25°C~+85°C

適用溫度

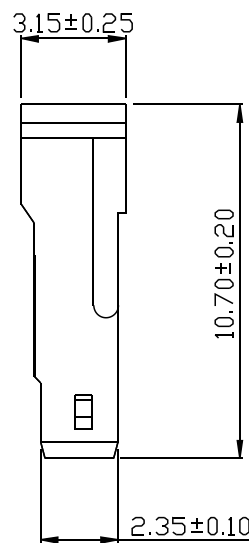
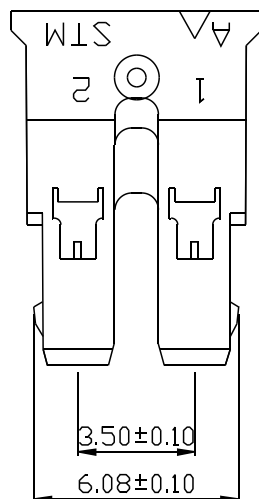
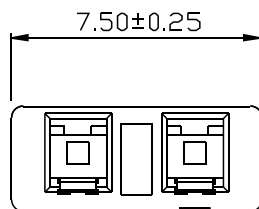

3.50mm

2408 Wire to Board Connectors



TERMINAL

Part No.: 2408-PS2

產品編號

Thickness: 0.20mm

厚度

Material: Phosphor Bronze (PS)

材質

Suitable Treatment: Tin-plated

表面處理

Applicable Wire: AWG#24~28

適用電線

Insulation O.D.: 0.90~1.70mm

線皮外徑

Suitable Housing: P2408P2

配合塑膠

Suitable Connector: M2408P2R MS2408P2

配合公座

Packing: 5,000PCS (Reel)

包裝數量

PERFORMANCE

Electrical Rating: AC/DC 1400V 1A

額定電壓電流

Insulation Resistance: 1000MΩ min.

絕緣阻抗

Withstanding Voltage: 3800V AC/minute

耐電壓

Temperature Range: -25°C~+85°C

適用溫度



3.50mm

